

1.00*1.00mm(0.039"*0.039") Board Space, Dual Row, SMT Type H=1.00mm

SPECIFICATIONS

Current Rating : 0.75AMP
 Contact Resistance : 30mΩ Max.
 Insulation Resistance: 1000MΩ Min.
 Withstanding Voltage : 500V AC/minute
 Operation Temperature: -40° C to +105° C
 Contact Material : Phosphor Bronze
 Contact plating : Gold Flash Plated
 Insulator Material : High Temperature Thermoplastic (UL94V-0)
 Standard: PA6T+30%G.F

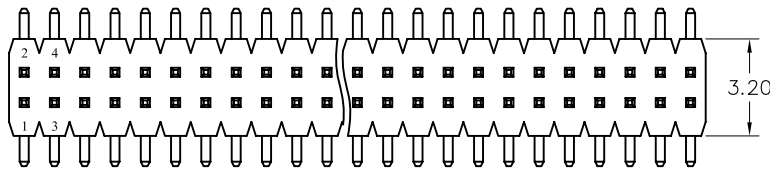

| | | |
|---|-----|-----|
| H | 1.0 | 1.5 |
|---|-----|-----|

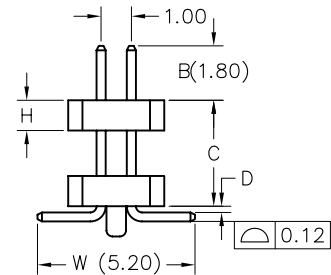
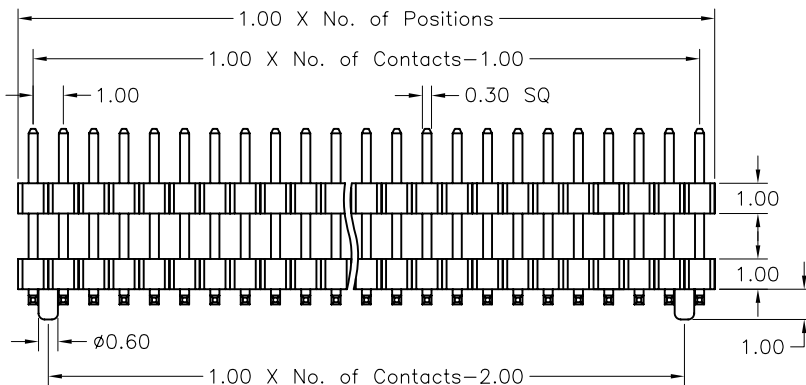

PEM2101 Series

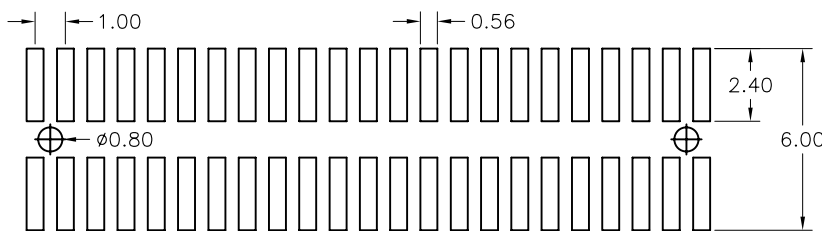

Recommended PCB Layout

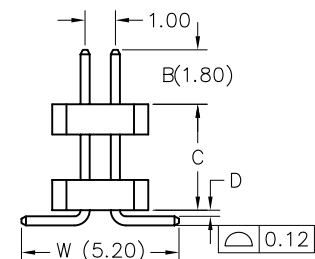

PEM2102 Series

Ordering Information

| | | | | | | | |
|---|---|------------------------------|--|---|---------------|---|---|
| PEM2102 | - | XX | XX | A | XX | B 1 A | X |
| | | | | | | | |
| Plastics Height 10:1.0mm 15:1.5mm | | No. of Pins Per Row 02~50 | Contact Plating 01:Gold Flash 02:Gold 2μ'' 03:Gold 3μ'' 04: Tin Duplex Plating 06:Gold Flash/Tin(100μ'') | | Serial Number | Material Type A:PBT B:NYLON 6T C:LCP D:NYLON 9T | Options A:BAG B:TRAY C:TUBE D:TAPE REEL |